



****AVAILABLE IMMEDIATELY****

****FURNISHED** **OFF STREET PARKING****

A outstanding top floor conversion apartment boasting over 640 Sq. ft of living space, ideally located Eskdale Terrace, within Jesmond's Brandling Village Conservation Area. Eskdale Terrace is perfectly placed close to the shops and cafés culture of Clayton Road, countless great restaurants and indeed Jesmond Metro Station.

Well presented throughout, the apartment occupies the top floor of this sensitive conversion and briefly comprises; private entrance hall with telephone entry system; 22ft open plan lounge/ modern fitted kitchen with appliances; two double bedrooms, both bright and very spacious, one of which also has a generous store cupboard housing the combi-boiler; plush recently installed bathroom WC. With gas central heating, double glazing and communal off street parking at the rear as well as on street permit parking to the front.

A fantastic property, ideal for a professional couple or sharers alike!

Available Immediately | £1,350pcm | Top Floor Conversion Apartment | 641 Sq. ft (59.6m²) | Two Double Bedrooms | Bathroom WC | 22ft Open Plan Lounge/Kitchen | Well Presented | Furnished | Off Street Parking | GCH & DG | Close To Jesmond Metro | Council Tax Band: B | EPC Rating: C

£1,350 PCM

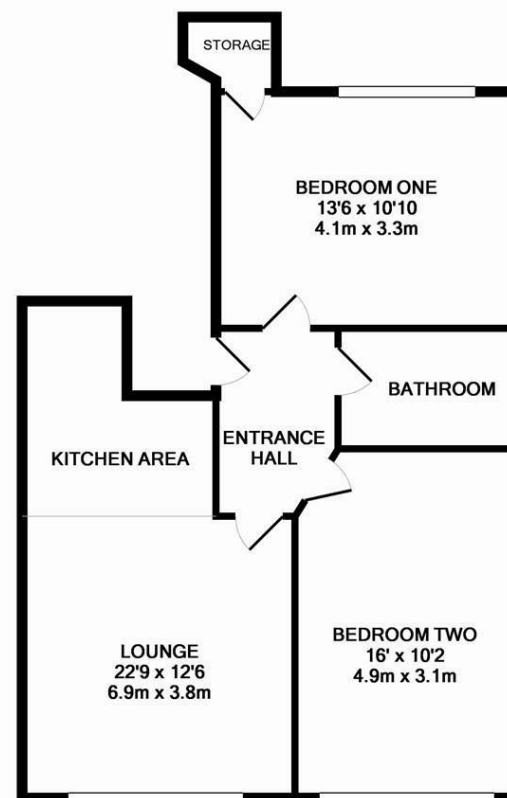

TOTAL APPROX. FLOOR AREA 641 SQ.FT. (59.6 SQ.M.)

Whilst every attempt has been made to ensure the accuracy of the floor plan contained here, measurements of doors, windows, rooms and any other items are approximate and no responsibility is taken for any error, omission, or mis-statement. This plan is for illustrative purposes only and should be used as such by any prospective purchaser. The services, systems and appliances shown have not been tested and no guarantee as to their operability or efficiency can be given
Made with Metropix ©2015

IMPORTANT NOTE: These particulars and the descriptions and measurements herein do not constitute representation and whilst every effort has been made to ensure accuracy, this cannot be guaranteed.

